

**“SFERA” Bollard ø400  
without tang**

**Sheet code:** *DIPP008*

**Drawing code:**

**Revision:** *23/01/2019*

**Designer:**  
*Bellitalia Design Department*

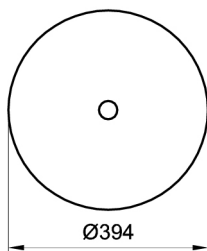
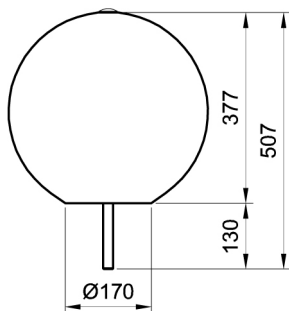

**Product:** Monolithic bollard model “SFERA ø400” without tang, with thread bar M20 for its fastening to the ground.

**Dimensions:** external diameter: 394 mm;  
maximum height: 547 mm;  
total weight: 83 kg;

**Material:** The bollard can be manufactured using reconstituted natural marble stones, white granite or grey concrete conglomerate. Steel thread bar M20.

**Reinforcing:** The bollard is reinforced and fitted with a bush that permits its lifting.

**Finishing:** The bollard’s surface can be polished, to give the product a shiny effect, or bush-hammered, for a rough appearance. The surface is then covered with a transparent anti-decay coating, or, upon request, with anti-graffiti products.

**Handling:** Use appropriate equipment when handling, screwing the eyebolt to the bush.

**Installation:** Drill a hole in the flooring, with a diameter of at least 24 mm and a depth of 150 mm; fill the hole with bi-component chemical anchors and introduce the bollard and the thread bar. If required, replace the lifting eyebolt with the specific brass screw.